

REVISIONS				
REV	SHT	ZONE	DESCRIPTION	DATE
A			INITIAL RELEASE	2014-03-24

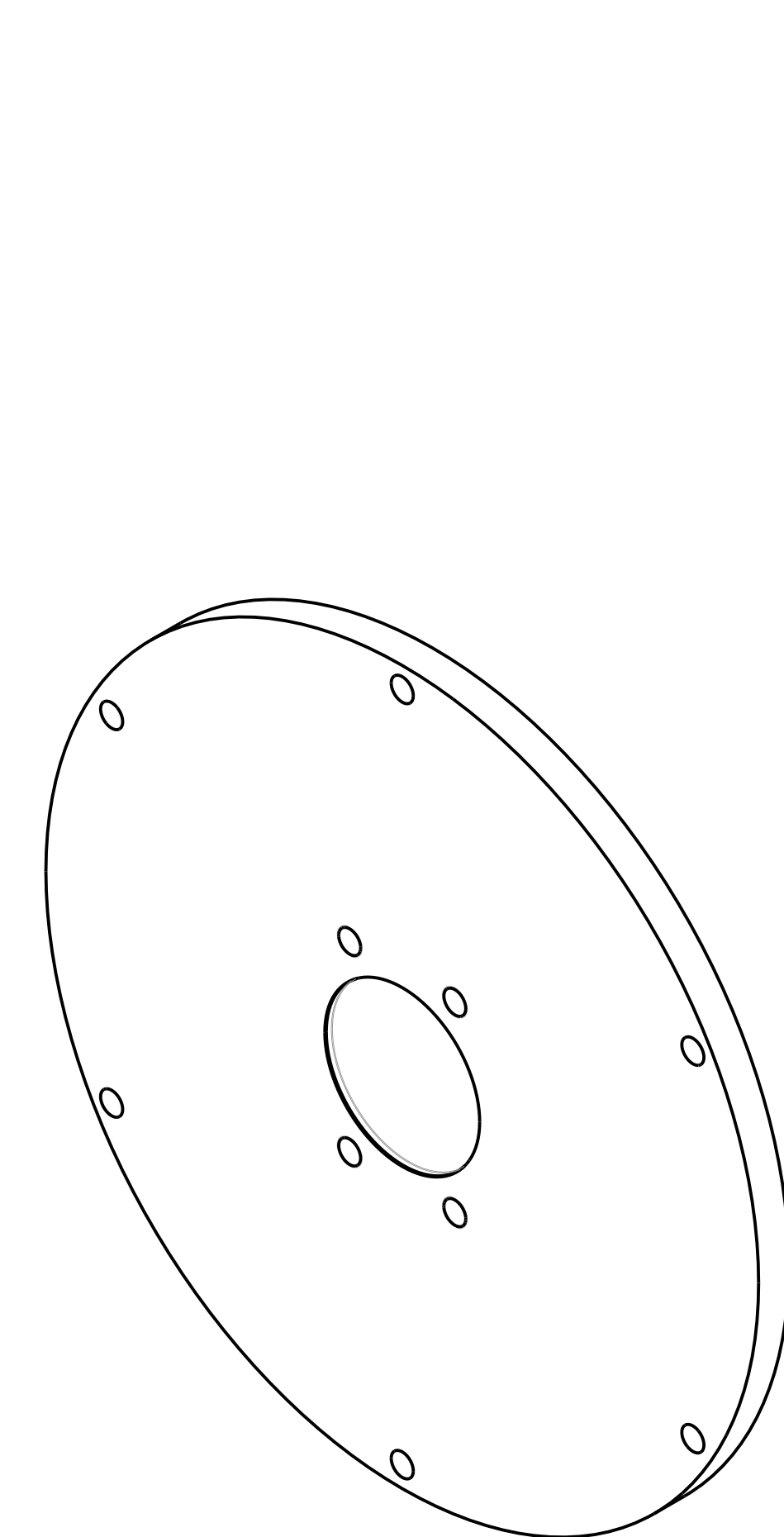

REFERENCE VIEW

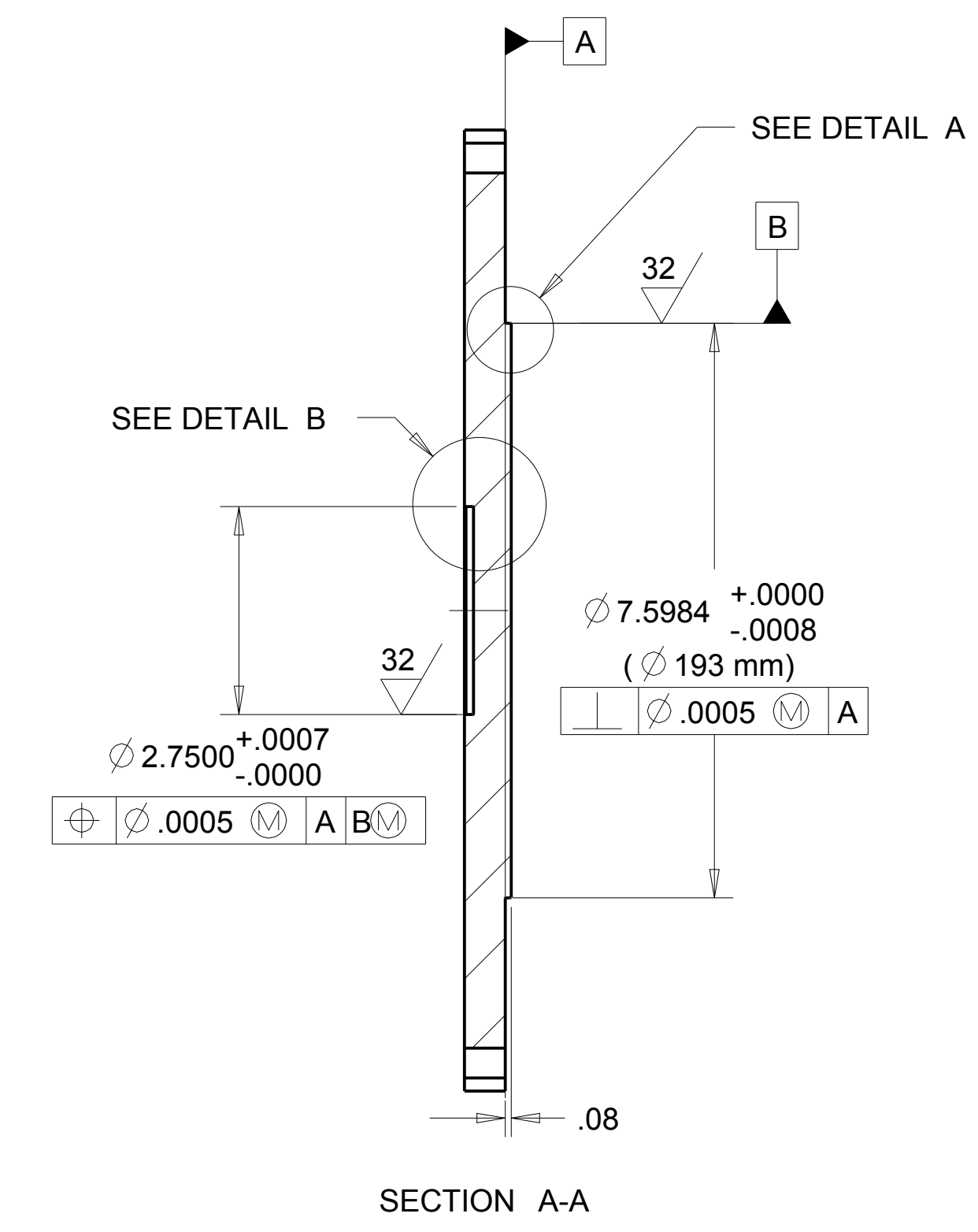
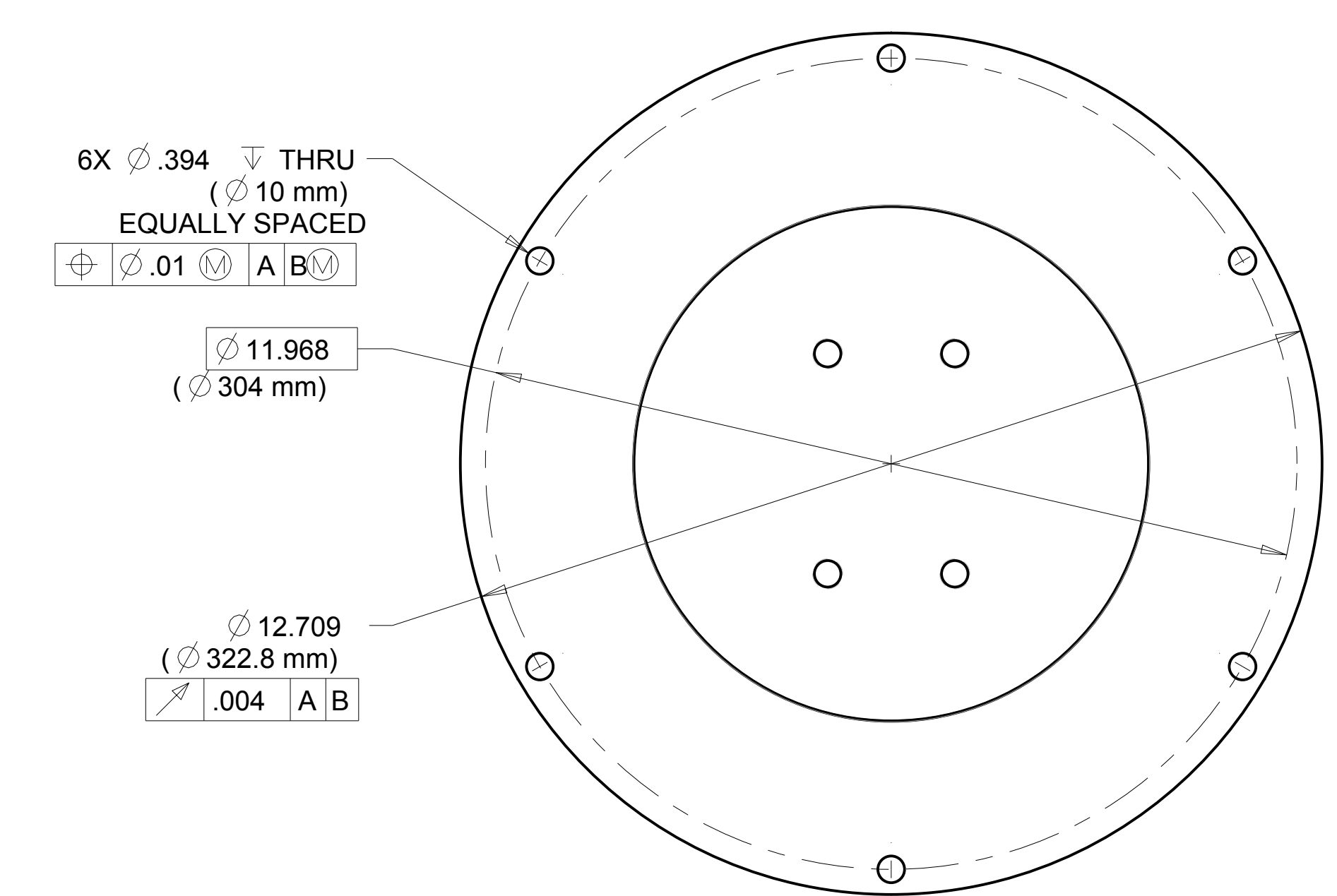
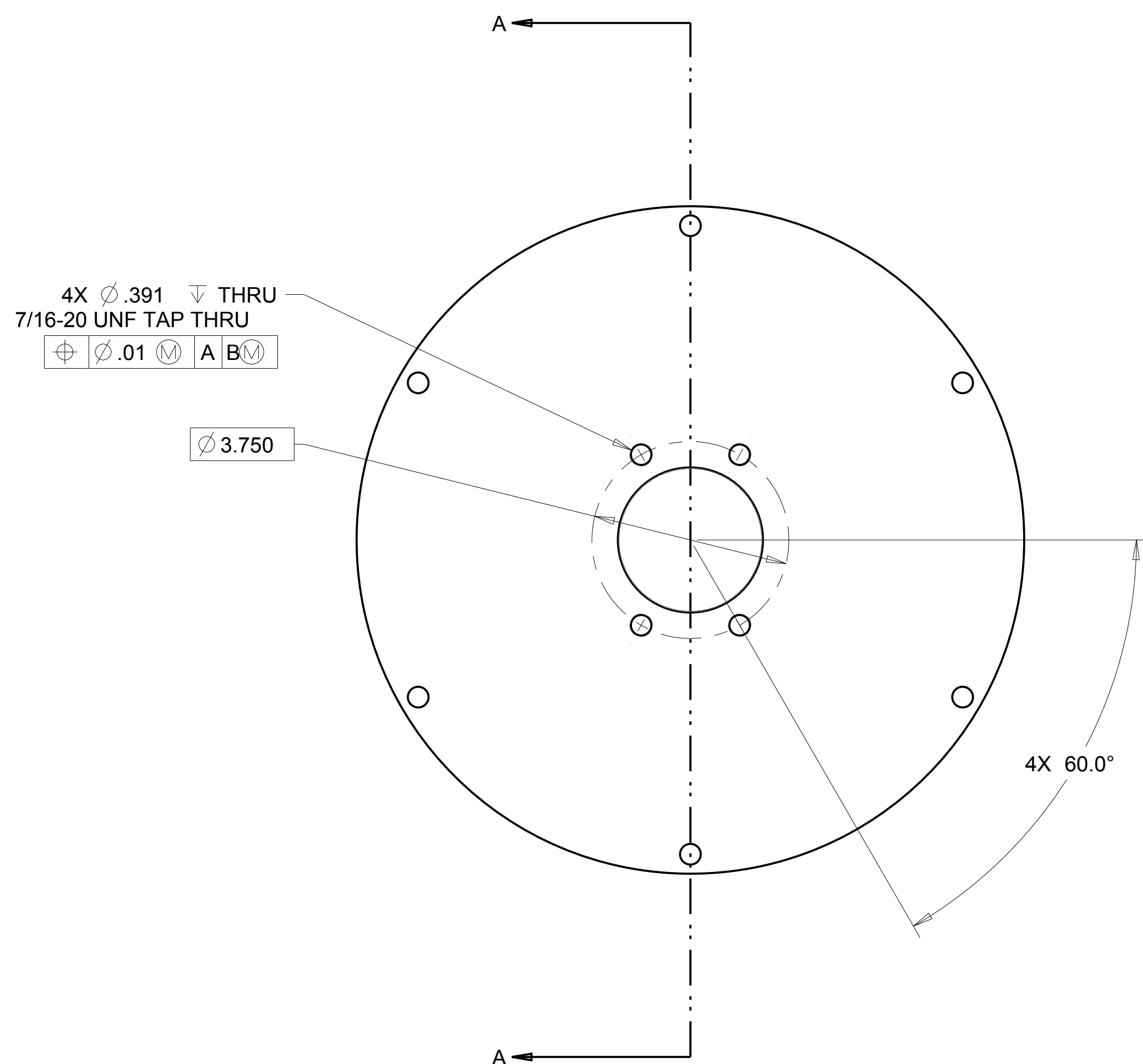

SECTION A-A

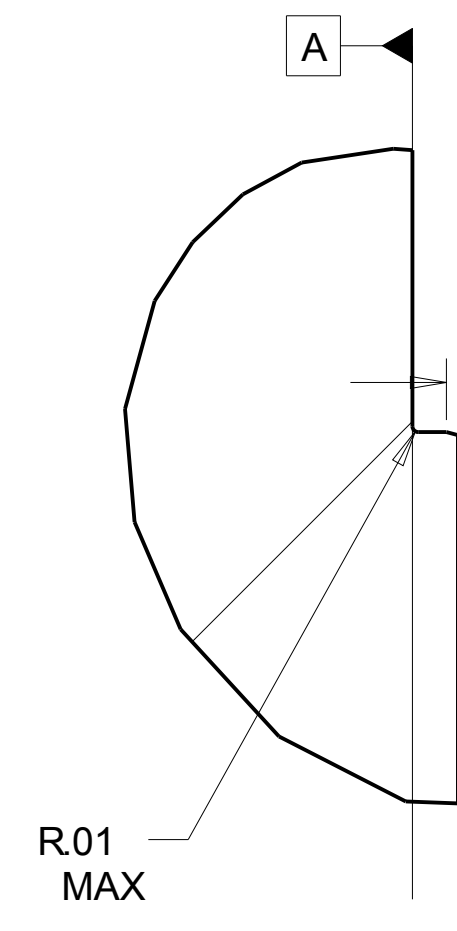

DETAIL A
SCALE 3.000

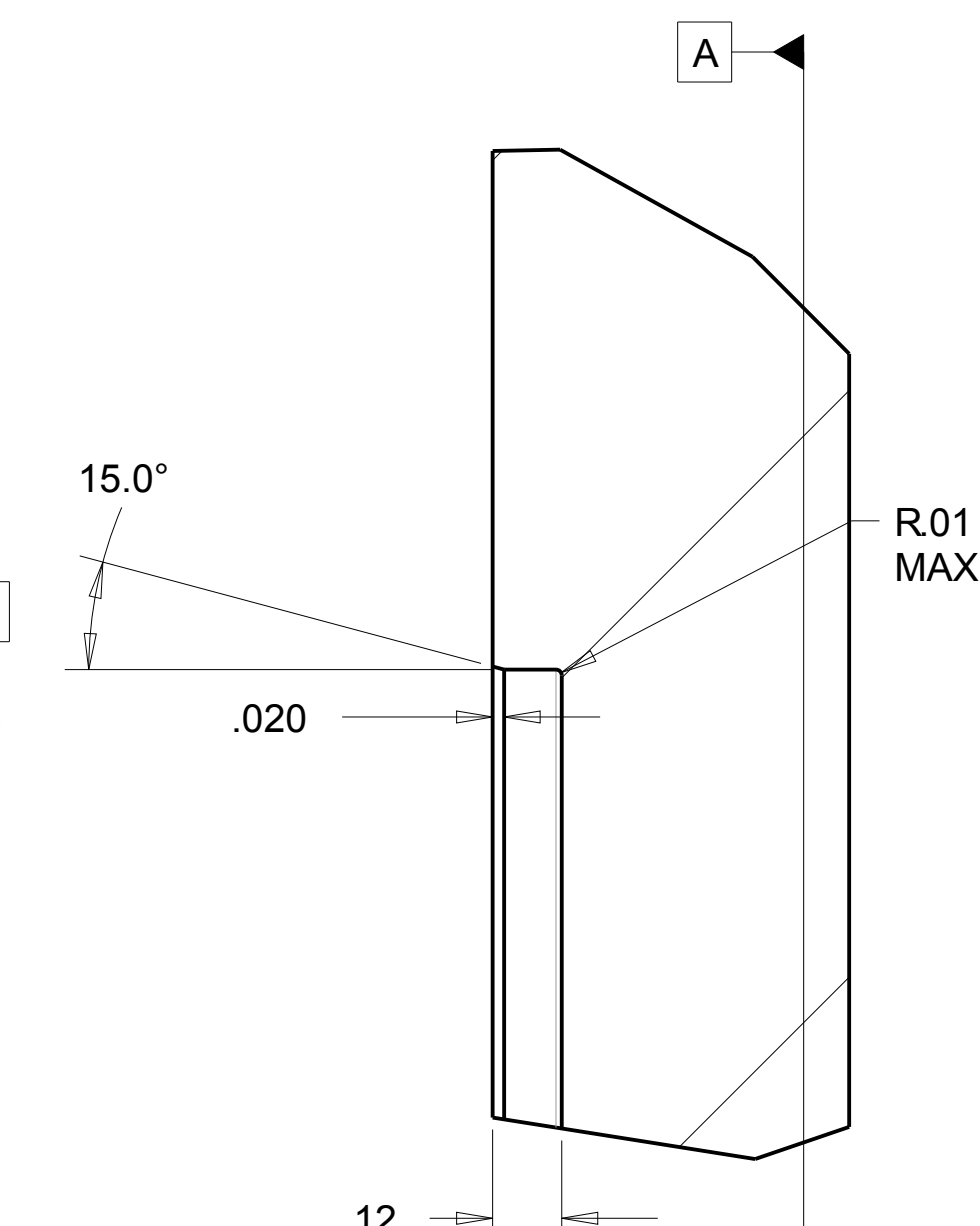

DETAIL B
SCALE 3.000

GENERAL NOTES

- 1) DO NOT SCALE THIS DRAWING
- 2) UNLESS OTHERWISE STATED:
 - a. ALL DIMENSIONING AND TOLERANCING IS IN INCHES PER ASME Y14.5-2009
 - b. BREAK ALL SHARP CORNERS AND SHARP EDGES R.010 MAXIMUM
 - c. MACHINED SURFACE FINISHES SHALL BE 125 MICROINCH OR BETTER
 - d. TAP DRILL DEPTHS SHOWN ARE MAXIMUM
 - e. FULL THREAD DEPTHS SHOWN ARE MINIMUM
 - f. CHAMFER ALL TAPED HOLES TO (NOMINAL DIA + 1/16) x 90°

QTY	CAGE	PART NUMBER	DESCRIPTION	MATERIAL/SPECIFICATION/NOTES	ITEM
			FLYWHEEL ADAPTER	ASTM A36 OR EQUIVALENT	
BILL OF MATERIAL/PARTS LIST					
DEFAULT TOLERANCES			APPROVAL SIGNATURES		
ONE PLACE (X.X) = ± 0.1			DRPT		
TWO PLACES (X.XX) = ± 0.01			CWD		
THREE PLACES (X.XXX) = ± 0.005			DSGN		
FOUR PLACES (X.XXXX) = ± 0.0005			PRCL		
ANGLES = ± 0.5 DEGREE			DATE COMPLETION DATE: 2014-03-24		
SURFACE FINISHES <= 125 MICROINCH RA			FILE MODEL: ADAPTER_ENGINE_FLYWHEEL		
THIRD ANGLE PROJECTION					
EXCEPT AS MAY OTHERWISE BE PROVIDED BY CONTRACT, THESE DRAWINGS AND SPECIFICATIONS ARE THE PROPERTY OF SOUTHWEST RESEARCH INSTITUTE, ARE ISSUED IN STRICT CONFIDENCE, AND SHALL NOT BE REPRODUCED, OR COPIED, OR USED AS THE BASIS FOR MANUFACTURE OR SALE OF ANY APPARATUS SHOWN THEREON WITHOUT PERMISSION					
D 26401		IIIH-FAP10		A	
SCALE 0.500		UNIT WEIGHT = LBS		SHEET 1 OF 1	

SOUTHWEST RESEARCH INSTITUTE
OFFICE of AUTOMOTIVE ENGINEERING
6220 CULEBRA ROAD SAN ANTONIO, TEXAS 78238

ADAPTER, ENGINE FLYWHEEL