

ISB5.9 Block
5449529 vs 5405082

Flywheel Housing
3959813 vs 3959811

Compare

Block PN 5449529 vs Block PN 5405082

Cyl	Bore Dia	Design Level	Casting P/N ID-11	Machined P/N ID-10	Assembly P/N ID-16	Vent Holes Between Cyl.	Cup Plug Locations	Notes
6	102	Echo 5.9L	4934261	3972843	5449525	NO		Service Only
6	102	Echo 5.9L	4934261	3972843	5449529	NO		Xler / Marine
6	102	Echo 5.9L	4934261	3963351	5449524	NO		Not Structured
6	102	Echo 5.9L	4934261	3963351	5405091	NO		MD / Industrial
6	102	Echo 5.9L	4934261	5260722	5405082	NO		MD / Industrial w/ PTO holes
6	102	CBL	3971414	3971415	5449526	NO	EEA-style	Hatteras

Front & Cold Side

5449529

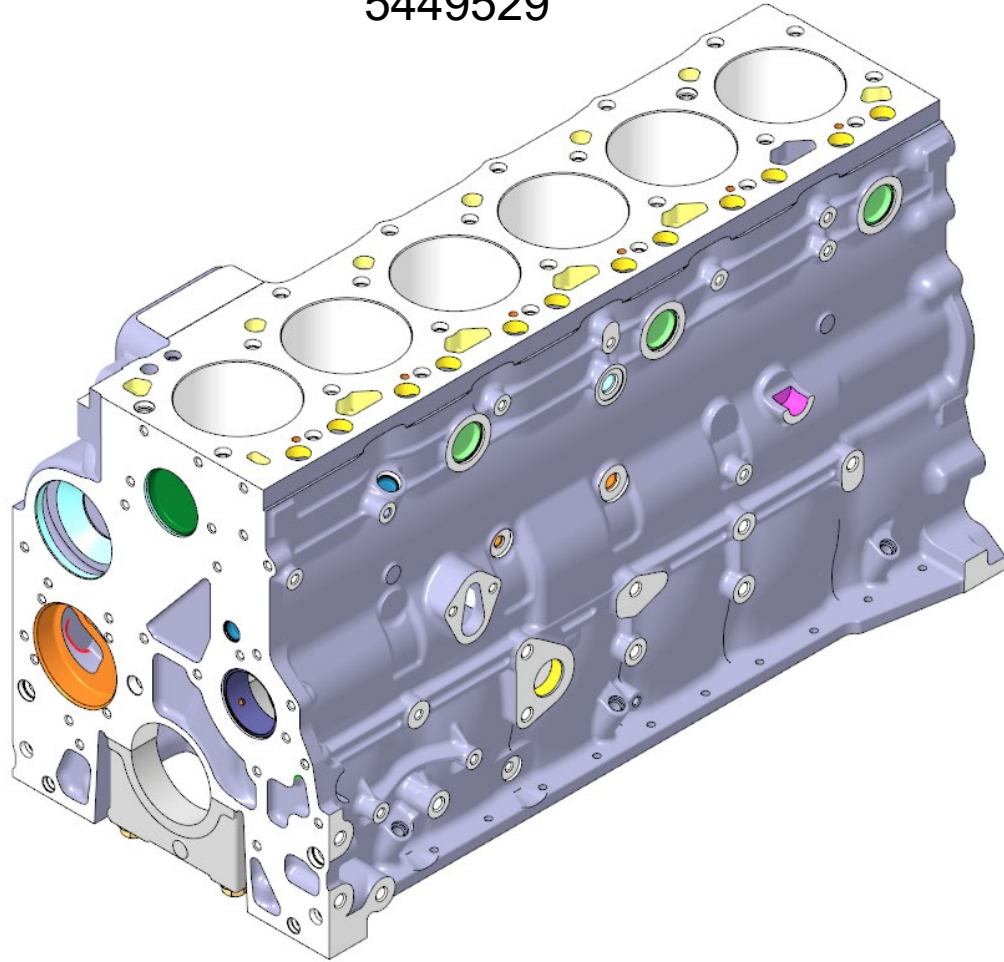

5405082

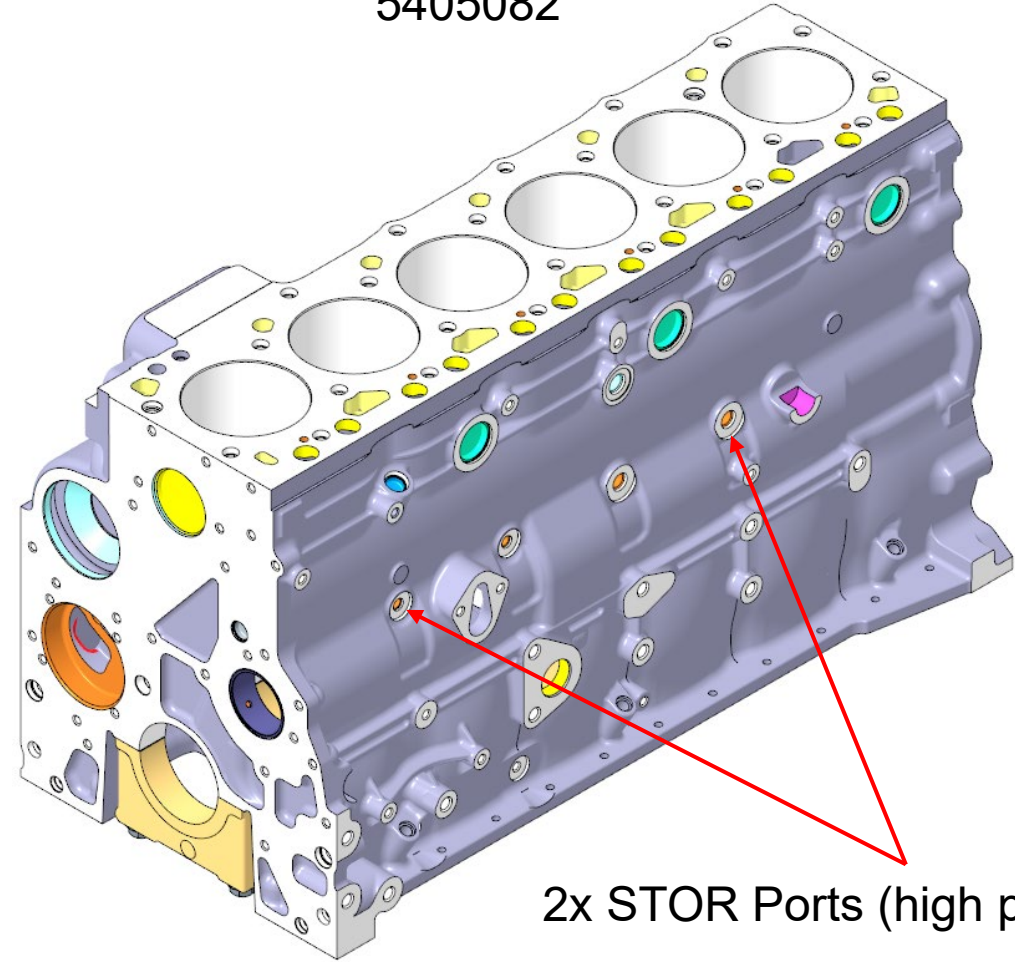

2x STOR Ports (high pressure oil)

Rear & Hot Side

5449529

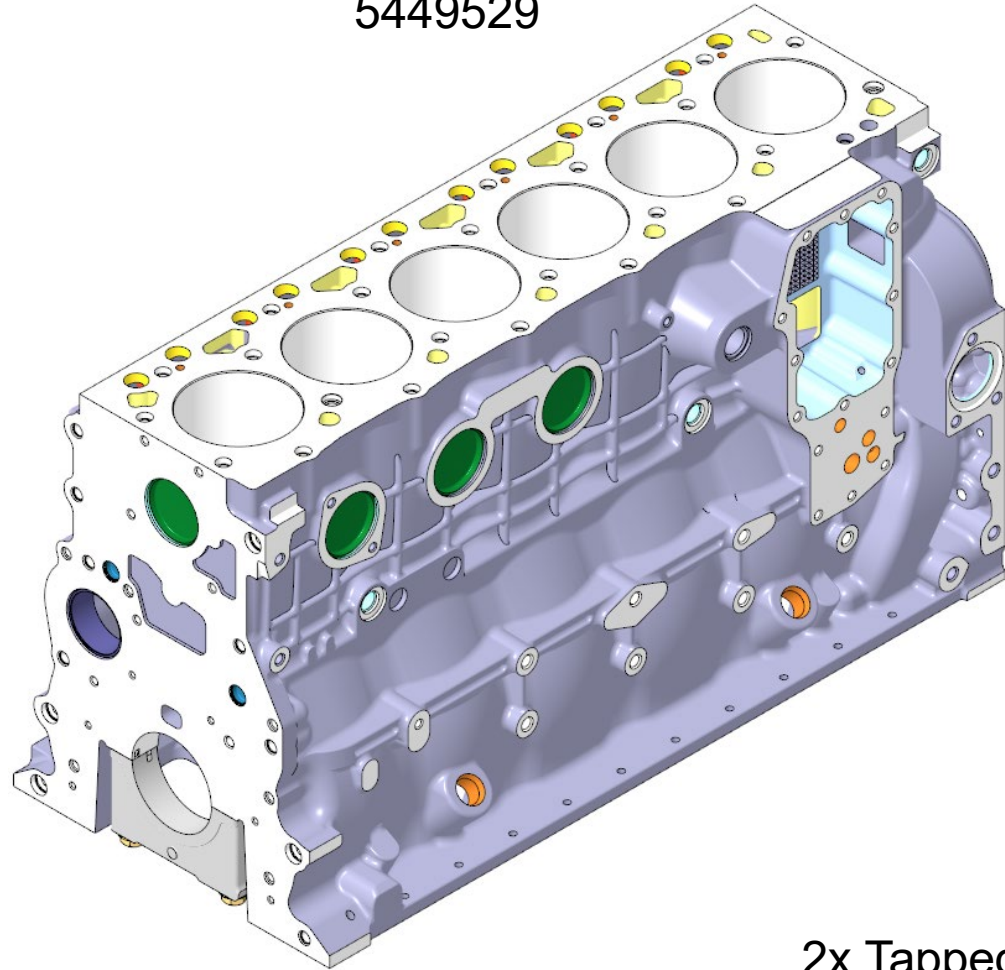

5405082

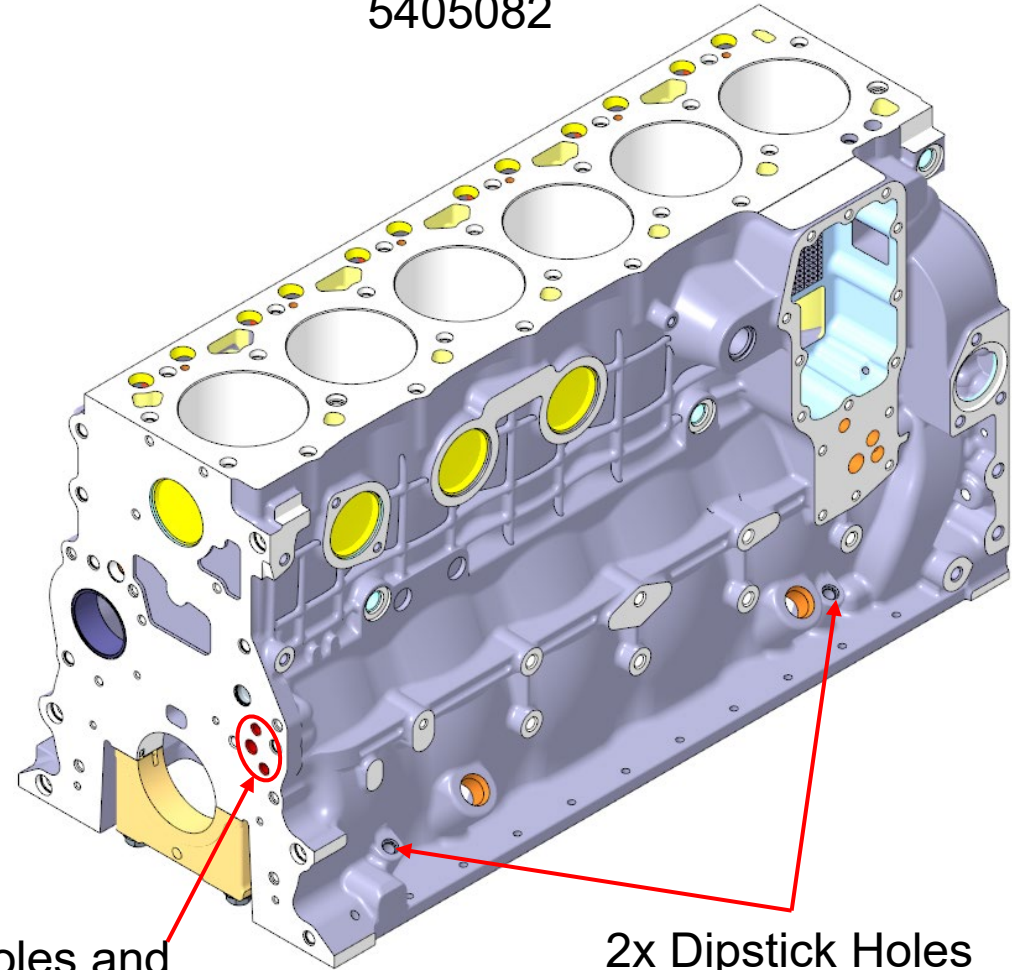

2x Tapped Holes and
Dowel Hole for PTO
(Power Takeoff)

2x Dipstick Holes

Bottom

5449529

6x saddle jet style piston
cooling nozzle holes

14x bedplate holes
19mm thread depth

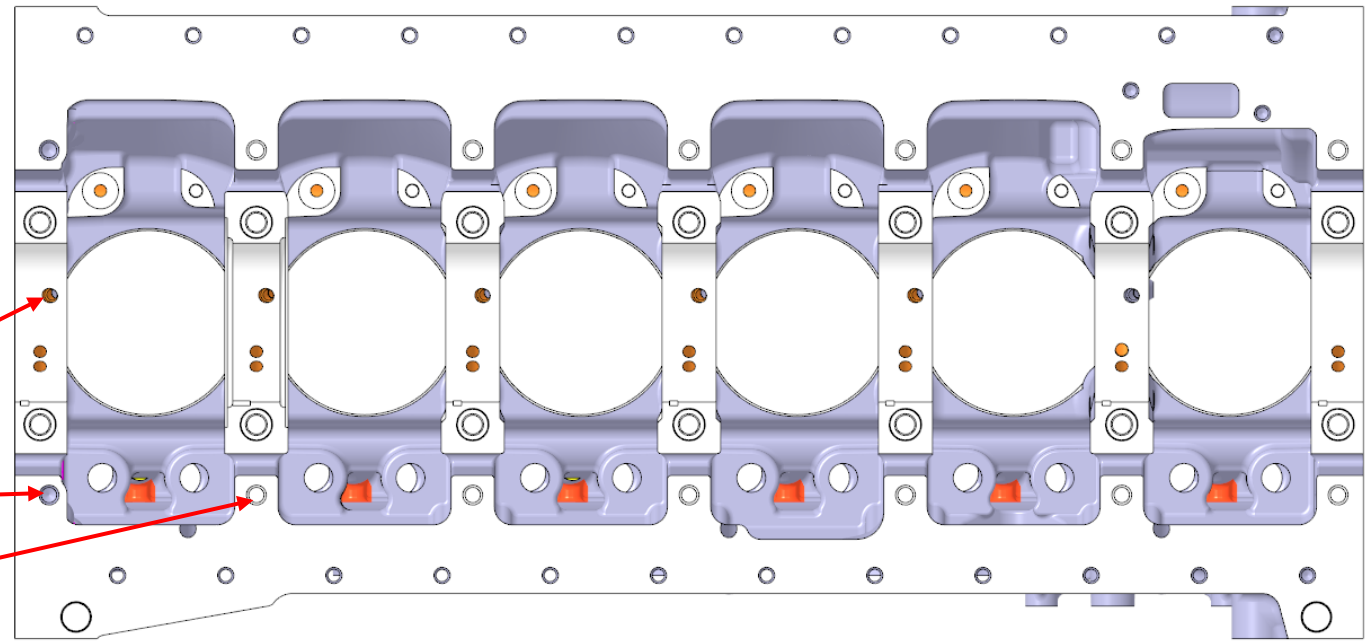

5405082

2x optional dowel hole
machining for balancer

12x bedplate holes
22mm thread depth

2x bedplate holes
20mm thread depth

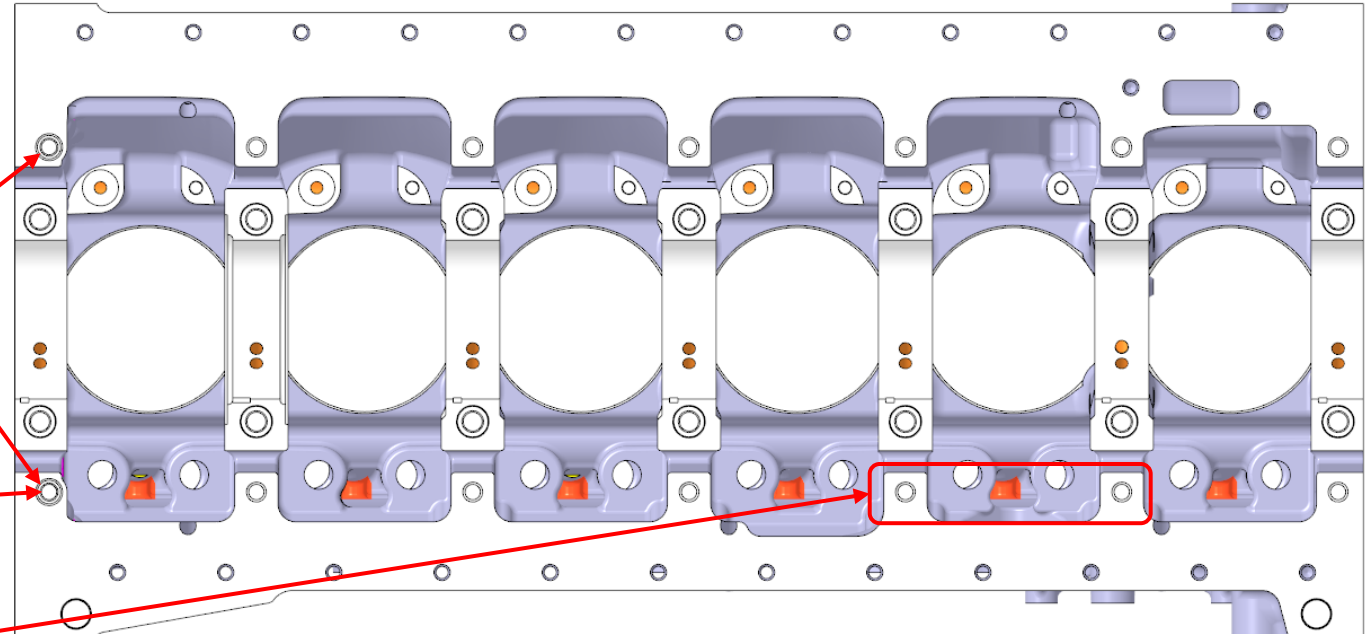

ISB 5.9 Flywheel Housing

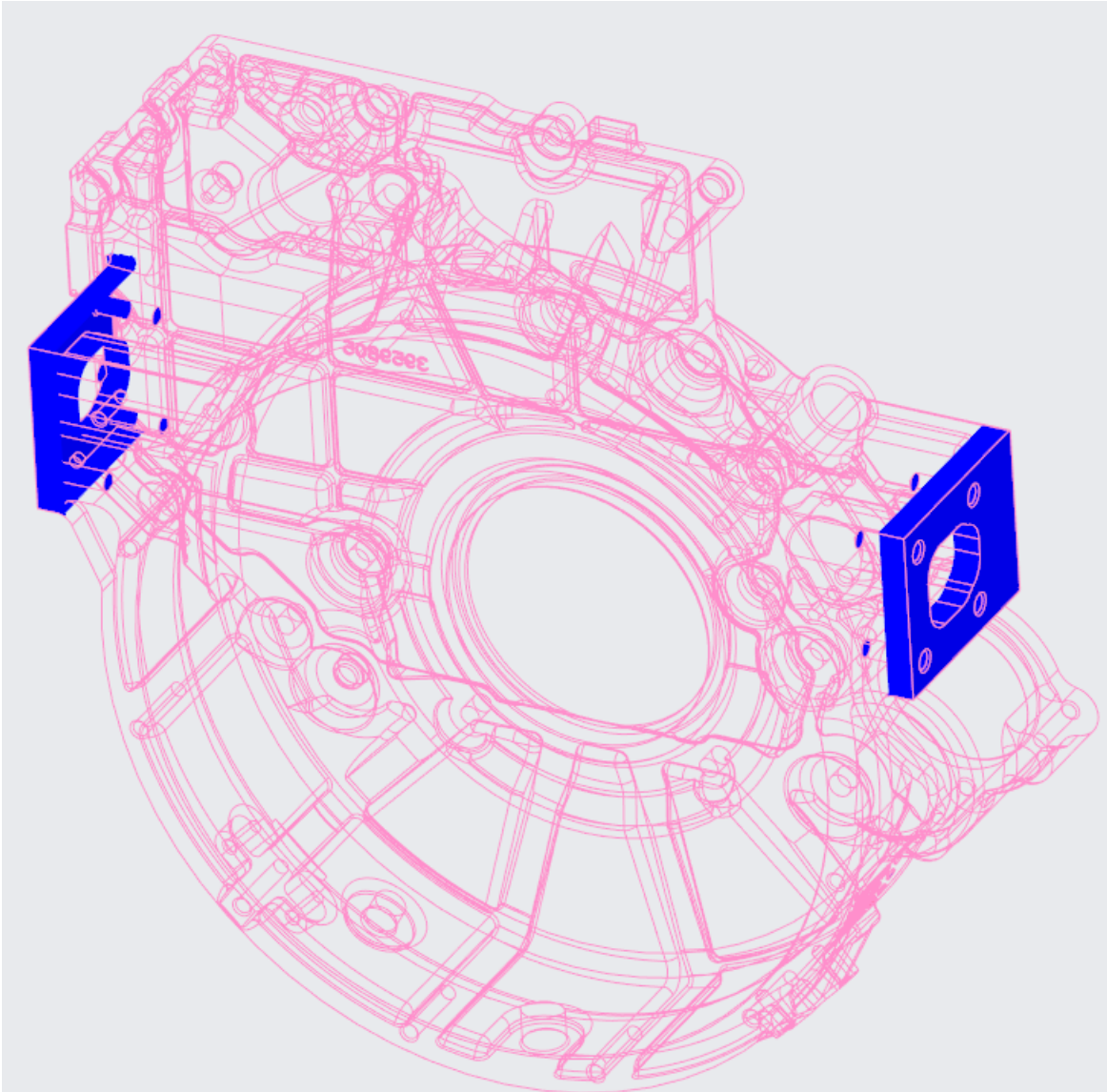

PN 3959813 (current) vs
3959811 (replacement)